

Sizes 40' x 10'

Executive Cabin with 6 Person Work Station
& 6 Person Conference Room + WC & Pantry

DSG-17

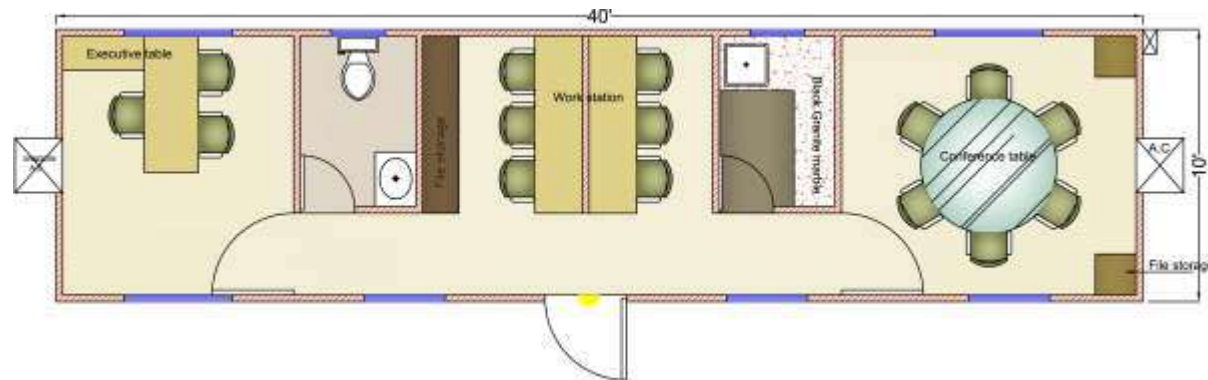

Sizes 40' x 10' Executive Cabin with 3 Person Work Station
& Conference Room + Urinal + WC & Pantry

DSG-18

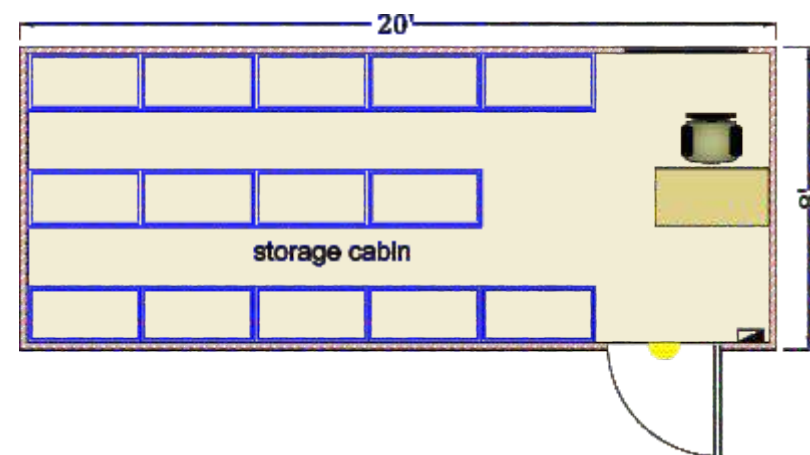
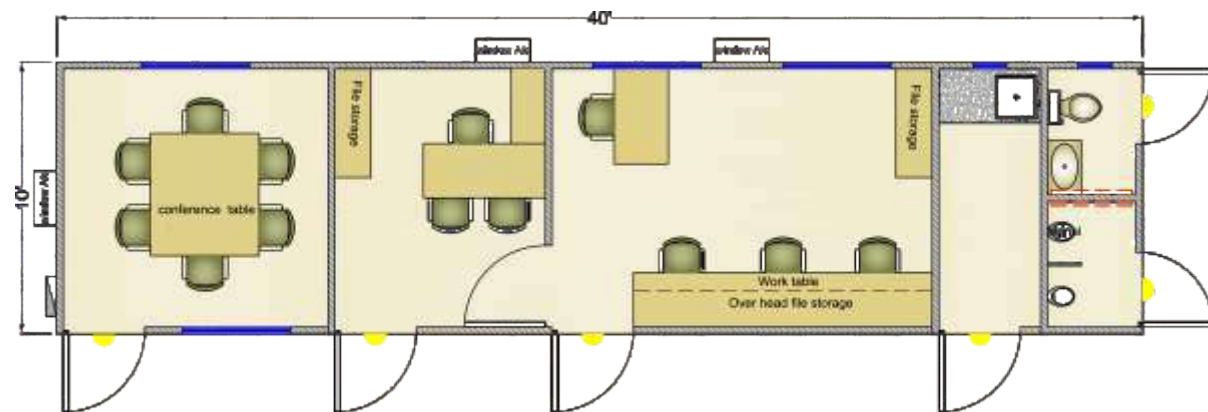

DSG-19

Sizes 20' x 8'
Storage Cabin
with Table

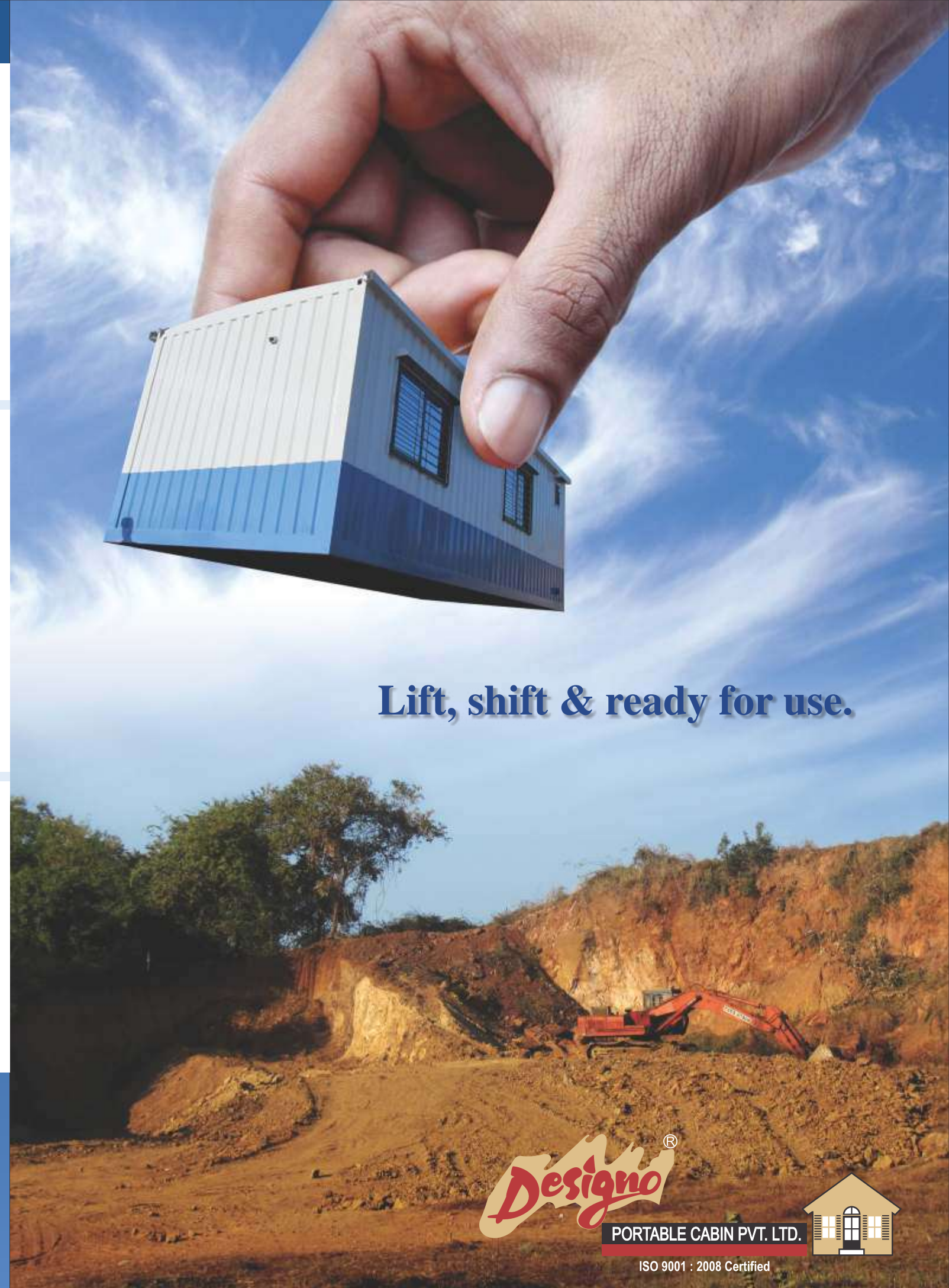

Lift, shift & ready for use.



PORTABLE CABIN PVT. LTD.

ISO 9001 : 2008 Certified



Designo Portable Cabin Pvt. Ltd.

Corporate Office:
Deshmukh Wadi, Near Chakreshwer Talav, Behind Samved Mitra Mandal,
Gaon Dhani, Umrale Road, Nallasopara (W), Tal - Vasai, Dist - Thane - 401203.
Telefax: (0250) 2404242. M. No. 9960515166 / 9850837794

Email: info@designocreation.com / designoindia2002@yahoo.com
Website: www.designocreation.com

ad 29 creativity-9920317691



PORTABLE CABIN PVT. LTD.

ISO 9001 : 2008 Certified



About Us

About Us

Designo Portable Cabin Pvt. Ltd. was established in 1990 The Company manufactures the following products

- A) Portable Cabin
- B) Door Frame
- C) Flush Door

Designo Portable Cabin has been following the basic tenets of business right from its inception and the principles of integrity, Commitment, fairness and ethics have always been accorded the highest priority.

A state of the art manufacturing facility has been set up for the above purpose and ISO certification has also been obtained for the facility.

The location of our factory is ideal for the smooth movement of raw material and finished goods.

Designo Portable Cabin Pvt. Ltd. in a short period of their existence have carved a niche in the pre- fab industry.

Our range of Porta cabins are designed and manufactured as per the standards of ISO. Our Porta-cabins are structurally sturdy, stable, earthquake-proof, weather-proof, termite-proof, leak-proof and can be adopted for any weather conditions. Moreover these units can be moved or shifted easily with the help of cranes or trailers.

**The first name Quality,
the last word in Prefabricated Structures**

Designo Portable Cabin offer widest range of designs and sizes for ease of selection.



Our Mission

At Designo Portable Cabin Pvt. Ltd. we endeavour to design, develop and manufacture the Industry's most advanced prefab structure using modern technology and converting the same into value-added products for our customers through our professional services and solutions.



Quality controls at each & every step...
to give you only the best.

Company Values

The Foundation of Designo Portable Cabin Pvt. Ltd. has been based on shared efforts and visions and thirst for improvement. These foundations can be summarised as a function of the following principles

- Integrity
- Commitment
- Team Work
- Innovation

Our Primary Goals

- To provide the best Office, storage, dwelling, and other solutions for varied applications.
- To provide the best infrastructure to our customers
- To develop a responsive and committed sales and service force
- To be receptive to new ideas.

**When its time to build
think of Designo Portable Cabin**

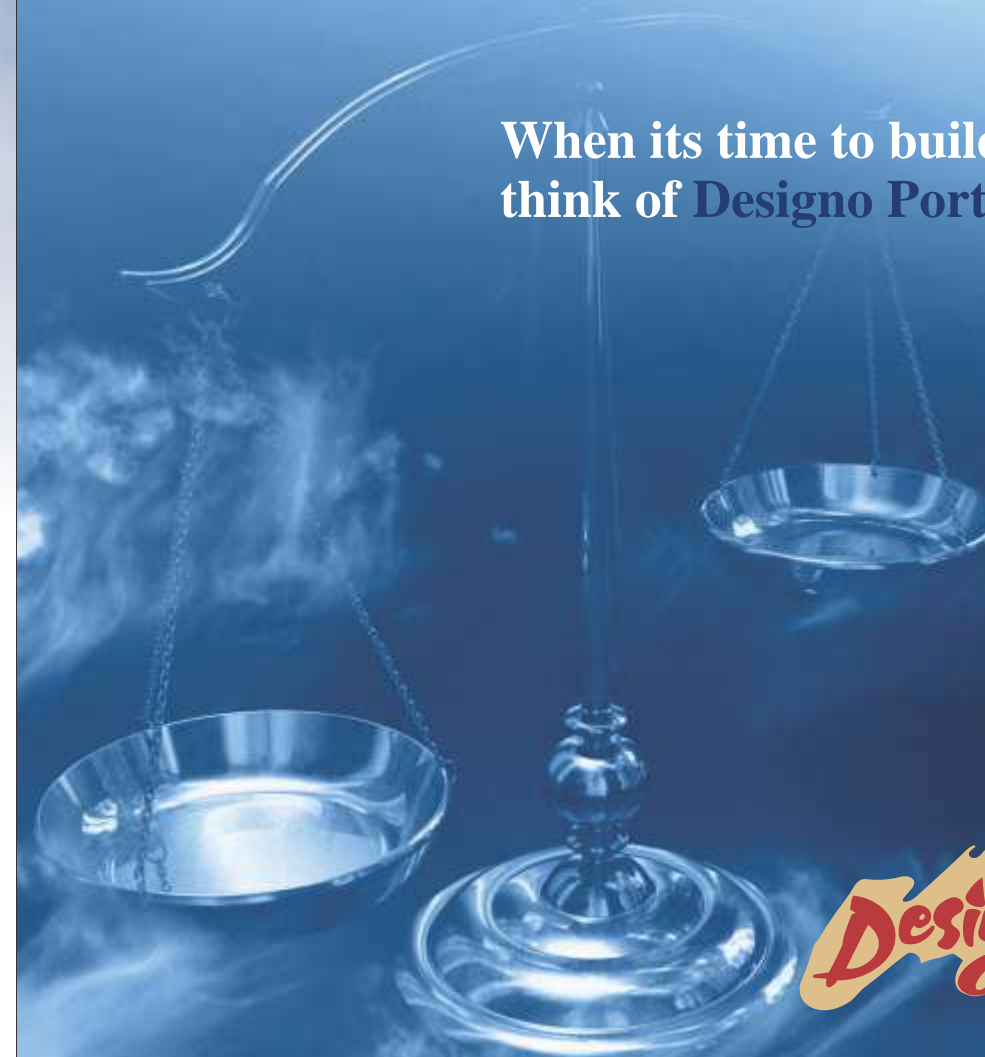

PORTABLE CABIN PVT. LTD.

ISO 9001 : 2008 Certified





Advanced engineering...
Excellent manufacturing...
Committed service...
That's the motto of Designo.

To achieve the above objective the company will

- Uphold all parameters to achieve quality
- Satisfy the customers' needs through innovation, process improvement and better study of end-use applications
- Encourage, Reward, and recognize our employees
- Be responsible environmentally and socially.

Advantages of Designo Portable Cabin

- Does not require any foundations.
- Tailor made factory/ shop floor cabins in G + ½ floors can be installed
- Available in different modules for your versatile needs.
- Saving on construction time
- Saving on site man power
- Inter-connected rooms may be created by joining 2 or more cabins.
- Ready to install
- Can easily be shifted to various site locations for re-use
- Zero maintenance cost
- Tailor made as per Design
- Can be easily lifted by hydra
- Lighting, air-conditioning, furniture, bath fittings, attachment etc. can be provided

Flexible, economical & time saving



PORTABLE CABIN PVT. LTD.

ISO 9001 : 2008 Certified





Filling Cabinet
& Work Station

USES

To suit your project
and budget allocation

Uses

As these Porta cabins do not require any foundations they are almost ready for use and they can be employed for the following applications
Temporary or permanent living Quarters



- Portable offices/Studios
- Mining camps
- Construction housing/field offices
- Worker housing
- Portable emergency clinics
- Storm shelters,
- Military/police posts
- Forest/mountain cabins
- Onsite Offices Units
- Training Shelters
- Onsite Accommodations units
- Security & guard house unit
- Kitchen units
- Mobile Hydro pneumatic systems
- Skid mounted units
- Mobile sewerage treatment plant
- Dining & mess units
- Equipment shelters
- Chillier & freezer units
- Diesel & water storage tanks
- Ablution units
- Septic tanks
- Prefab Villas/chalets
- Resort Complexes
- Farm Houses
- Motels & Caravan parks
- School Buildings
& Community Centers
- Mobile Warehouses.
- Lodging Container Units

Thus Porta cabins can be employed in various applications.

Our furnished **Galvanized** cabins are durable, strong, and rugged and make optimum use of space. This makes them perfectly suitable for emergency conditions like earthquake, hurricanes etc.

Our Portable cabins are engineered to perfection and are easily adaptable to suit variable climatic conditions. Selected Raw materials that undergo the rigorous testing procedures of our company are used in the manufacture of our cabins.



PORTABLE CABIN PVT. LTD.

ISO 9001 : 2008 Certified





Portable Toilet Block Specifications



Portable Toilet Block Specifications

- 1 BASE :** The main bottom (Base) frame is a part of an IS container, framework on which 19mm Bison Board and marine ply mounted with vinyl.
- 2 ROOF:** Top outer curved Galvanized plane sheet welded with M.S Frame structure Top inner decorated with partical laminated board of good quality.
- 3 ELECTRICAL:** Quality electrical product conforming of ISI standard will be used.
- 4 WALL PANEL :** outer wall will be of made by Galvanized corrugated sheet and inner wall will be decorated by water proof Bakelite sheet or hardner sheet.
- 5 DOOR:** Outside door will be of Galvanized corrugated sheet and internal door will be of Marine Flush Door with Laminated or FRP door.
- 6 PAINT:** phosphating the cabin internally & externally & painting with coat of epoxy primer with two coats of epoxy top coat.
- 7 INSULATION:** Special quality insulation is used to maintain a cool interior.



PORTABLE CABIN PVT. LTD.

ISO 9001 : 2008 Certified



Specifications



Site Office

Specifications of Galvanized (G. I.) Containerized Portable Cabin (Bunk House)

1 Size: Presently cabins of the following standard sizes are being offered off the shelf. However other sizes can also be manufactured upon specific orders. Our team of Engineers also provide valuable guidance in selecting and also in designing of special requirements.

2 Shell & Base Frame: The main bottom (Base) frame is part of an IS container framework on which 18 mm bison board or marine ply is mounted with vinyl flooring.

3 Side post: Specially formed 3.15 mm MS post section (Container type corner post to take a load of 10,000 kgs.)

4 G.I. Door: Door frame work by square pipe external wall made by **Galvanized** corrugated sheet & the inner wall will be decorated by laminated particle board & suitable locking arrangement.



5 Roof:

- The top of the cabin comprises **Galvanized** sheets, each sheet will have overlap on all sides & sheet will be fully welded using **Co2 welding** to prevent ingress of water.
- Bottom shall be pre-laminated board.
- Cavity filled with special density thick insulation to avoid overheating.
- Air-gap shall be created in between the sheet & the insulation for further Reduction in thermal conductivity using special roof cooling system.

6 Welding: The containerized bunk house shall be of all welded steel construction using the latest method of **MIG (Co2) argon shield gas**.

7 Window: Sliding type powder coated window with grill & will be protected by weather shades.

8 Outer wall panel: Outer wall will made by **Galvanized** corrugated sheet.

9 Inner wall panel: 9 mm decorative laminated sheet shall screwed on the side wall on the internal. All vertical & horizontal corners shall be neatly finished off The roof shall be of 9 mm decorative laminated sheet with aluminum powder coated beading. The ceiling of the roof shall be suspended from inside an IS Container.

10 Insulation: Special quality insulation is used to maintain a cool interior.

11 Partition wall: All partition walls frame made out of 50 mm x 50 mm x 16 g sq.pipes 9 mm panelling of particle board on both sides of wall with concealed wiring & concealed switch socket board

12 Electricals:

- All wiring shall be ISI mark of reputed make.
- Switches shall be ISI mark
- Concealed wiring shall be provided.
- Main input plug adaptor for efficient & leak-proof flow of current.
- M.C.B, ELCB shall b provided for additional safety.
- Air-conditioning units may be provided wherever required.
- Louvered exhaust fan for removal of foul air in the toilet area.

13 Furniture: As per the customer's specific requirement.

14 Painting: phosphating the cabin internally & externally & painting with coat of epoxy primer with two coats of epoxy top coat.

15 Site Preparation: The ground on which the portable cabin will be placed must be levelled and sufficiently hard to withstand the weight of the portable at the four corners. It is well advised to ensure that level is maintained.



PORTABLE CABIN PVT. LTD.

ISO 9001 : 2008 Certified





Instant prefab solution
to your space problem



PORTABLE CABIN PVT. LTD.
ISO 9001 : 2008 Certified





Our Clients



PORTABLE CABIN PVT. LTD.

ISO 9001 : 2008 Certified



- **Require very light foundation**
- **Durable, Comfortable, Strong, Earthquake-safe**
- **Easy to transport and erect**
- **Suitable for all weather conditions**

Our standard sizes for Galvanized Containerized Portable Cabin (Bunk House)

A) Office Cabin

Sr. No	Length (Feet)	Width (Feet)	Height (Feet)
1.	10'	10'	8.6"
2.	20'	10'	8.6"
3.	30'	10'	8.6"
4.	40'	10'	8.6"

B) Security Cabin

Sr. No	Length (Feet)	Width (Feet)	Height (Feet)
1.	4'	4'	8.0"
2.	6'	4'	8.0"
3.	6'	6'	8.0"
4.	8'	8'	8.0"

C) Toilet Block

Sr. No	Length (Feet)	Width (Feet)	Height (Feet)
1.	4'	4'	8.0"
2.	6'	4'	8.0"
3.	8'	8'	8.0"
4.	12'	5'	8.0"
5.	15'	8'	8.0"

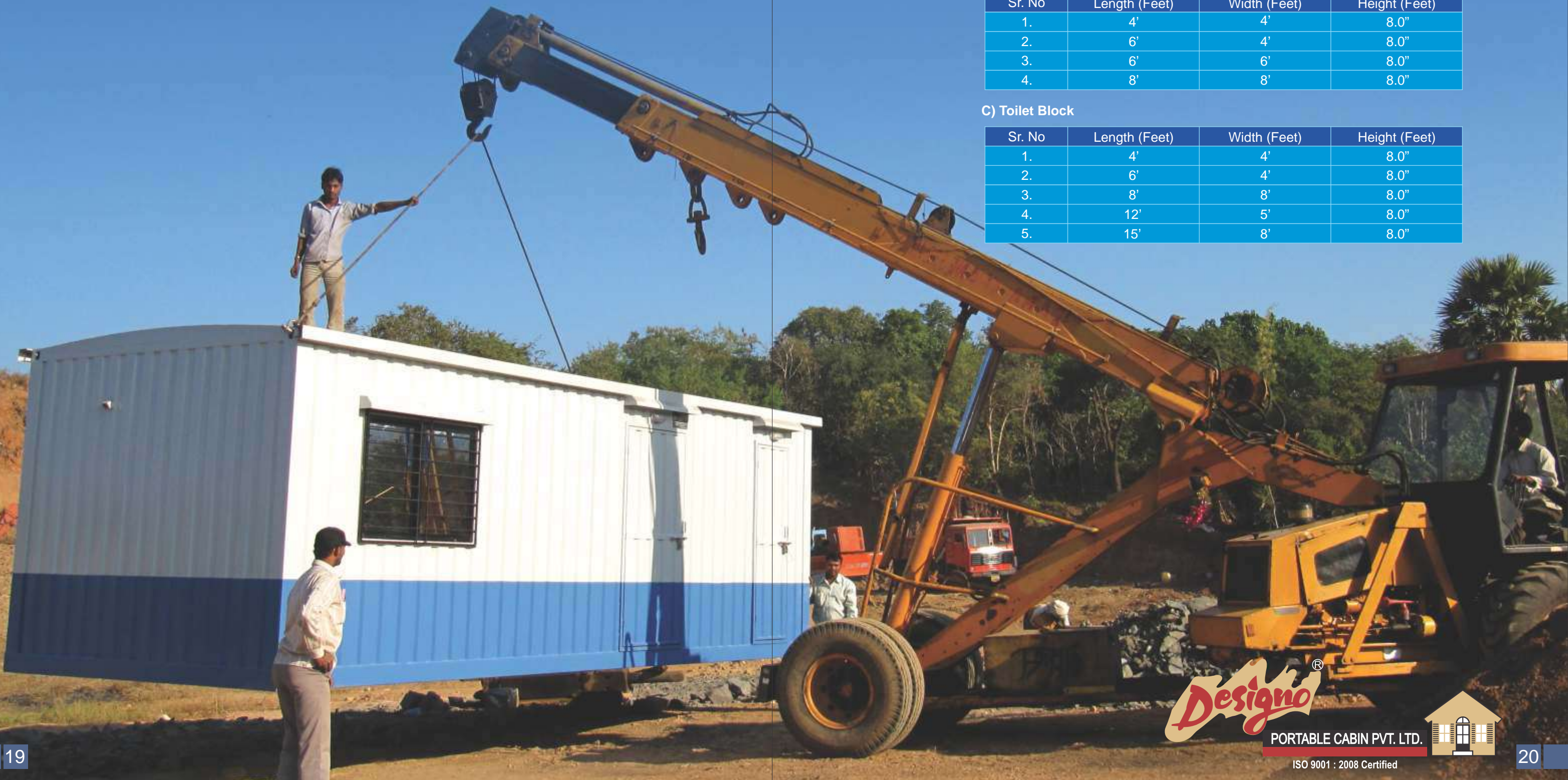

PORTABLE CABIN PVT. LTD.

ISO 9001 : 2008 Certified





Sizes 30' x 10'

Executive Cabin with Work Station & Reception Area

DSG-2

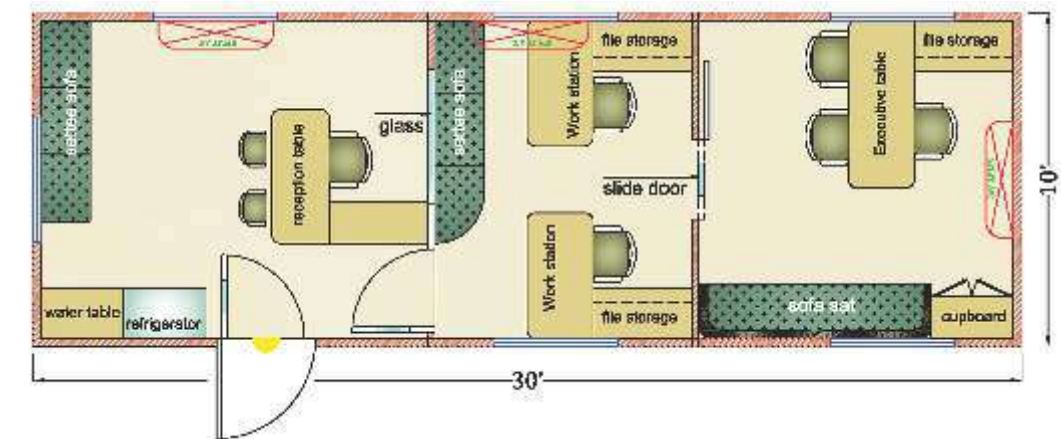

Sizes: 20' x 10' - Executive Cabin with Reception Area

DSG-1



Sizes-40' x 10'
4 Person Accommodation with 2 WC + 2 Washroom

DSG-3

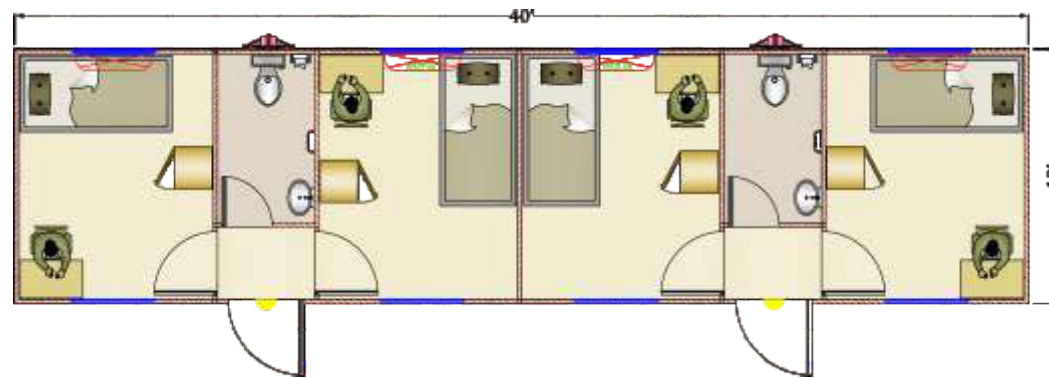

Sizes-40' x 10'
8 Person Accommodation with Locker

DSG-5

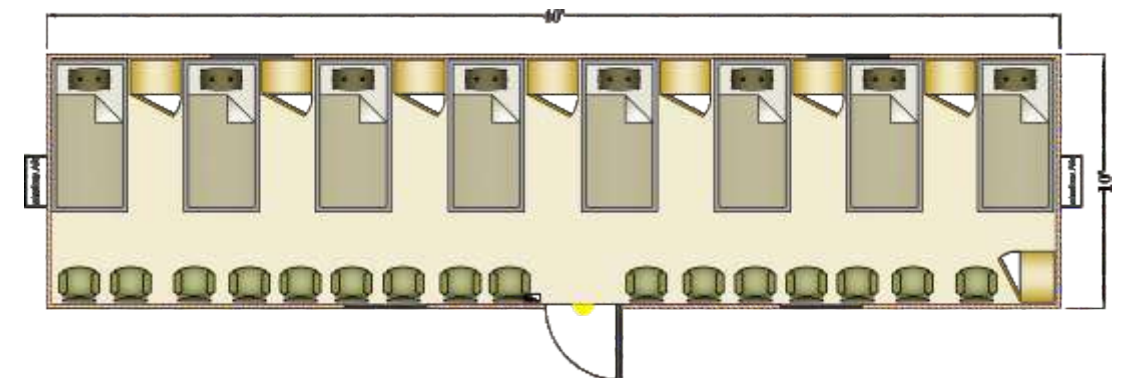

Sizes-30' x 10'
1 Bed, Hall & Kitchen

DSG-4

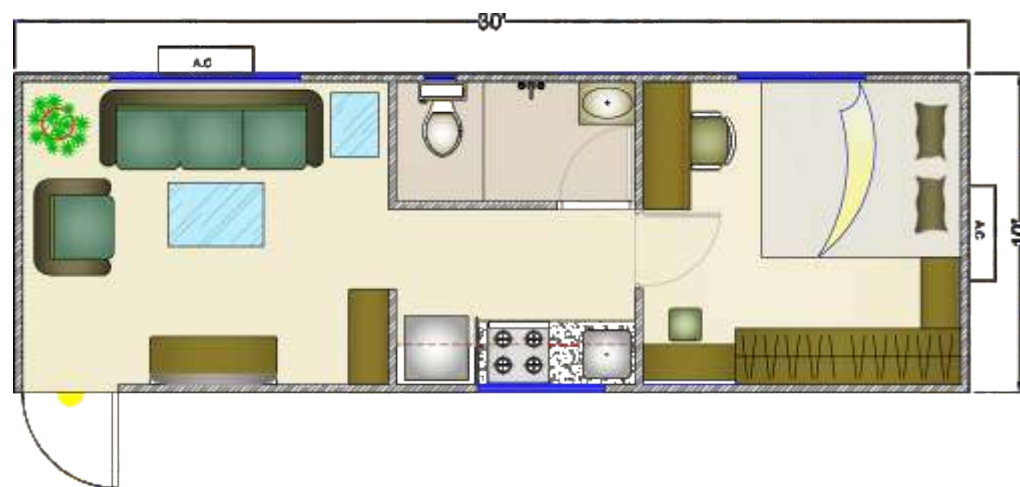

Sizes-30' x 10'
3 Person Accommodation with 6 Person Work Station
WC + Washroom

DSG-6

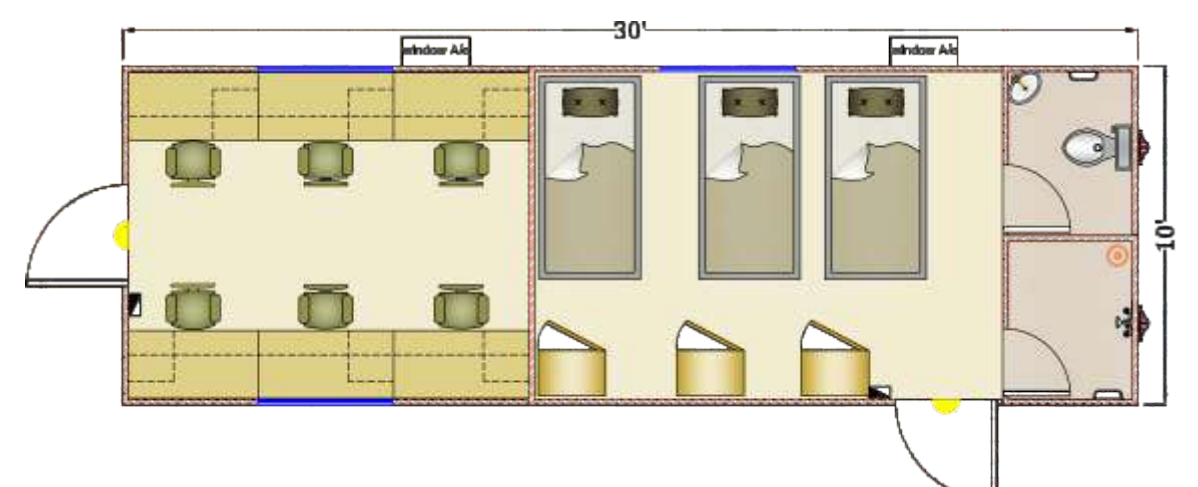

Sizes-20' x 10'
3 Person Accommodation with WC & Bath

DSG-5

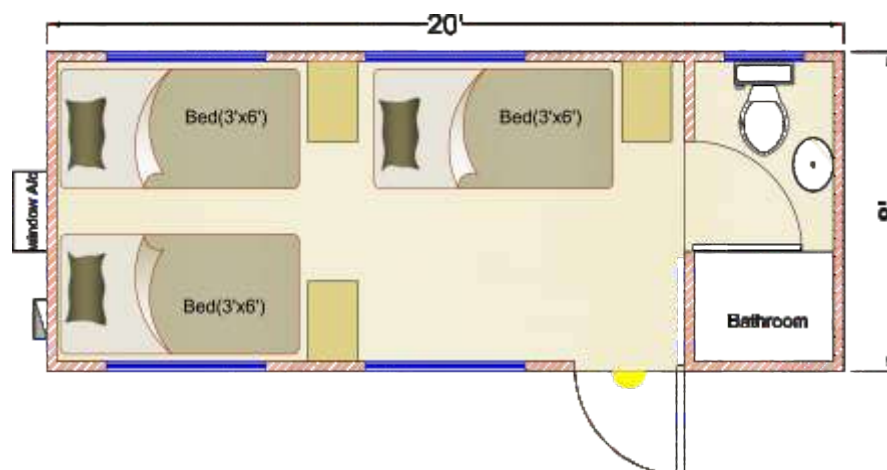

Sizes-30' x 10'
2 Executive Cabin & 1 Reception with WC & Pantry

DSG-7

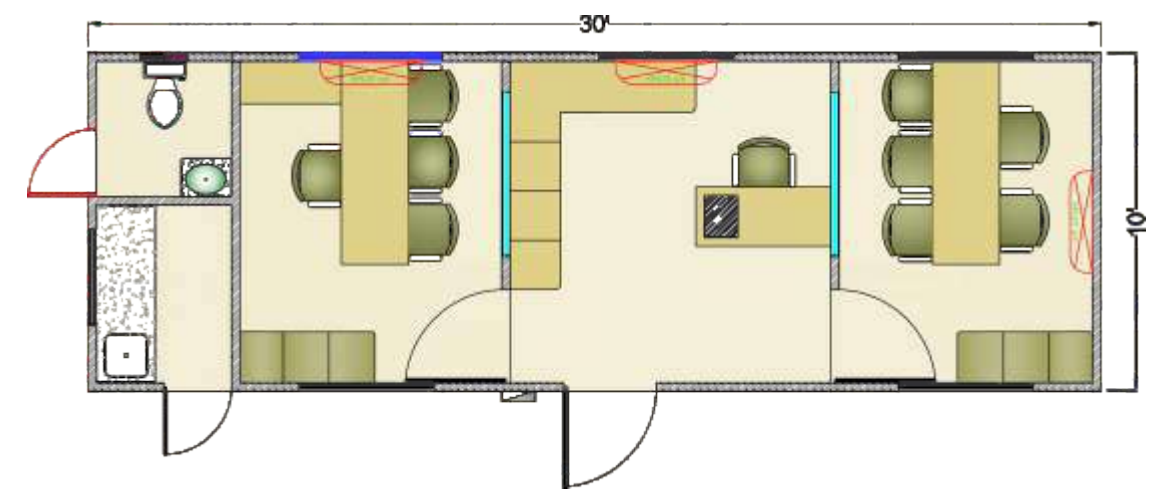

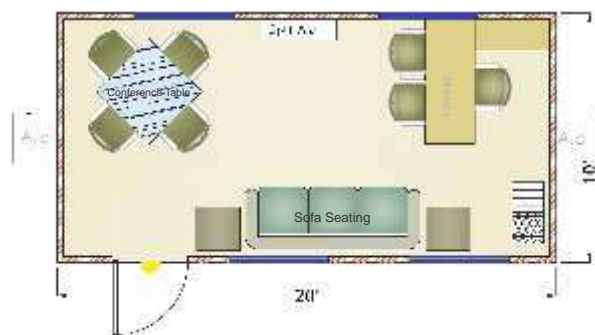

DSG-8

Sizes-20' x 10'
Executive Table with 4 Person
Conference Table with Reception

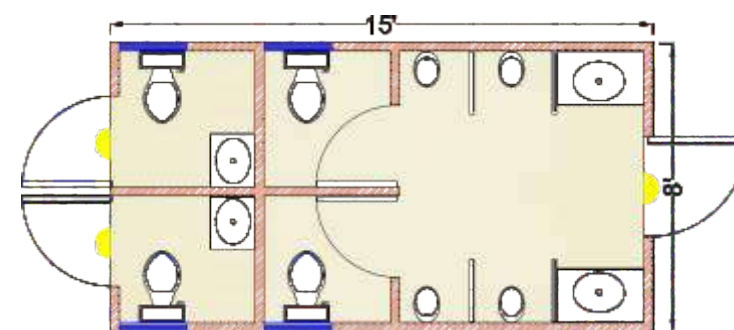

DSG-12

Sizes-15' x 8'
Toilet Block-4WC with 4 Urinal

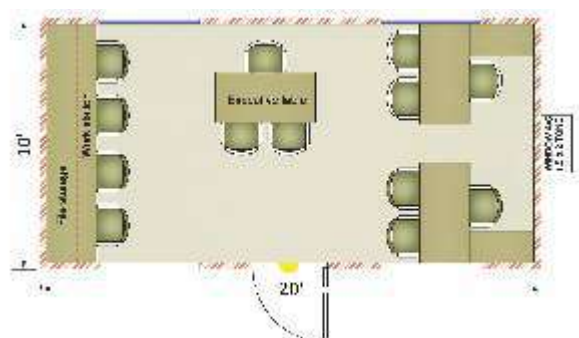

DSG-9

Sizes-20' x 10' - 3 Executive Table
with 4 Person Work Station

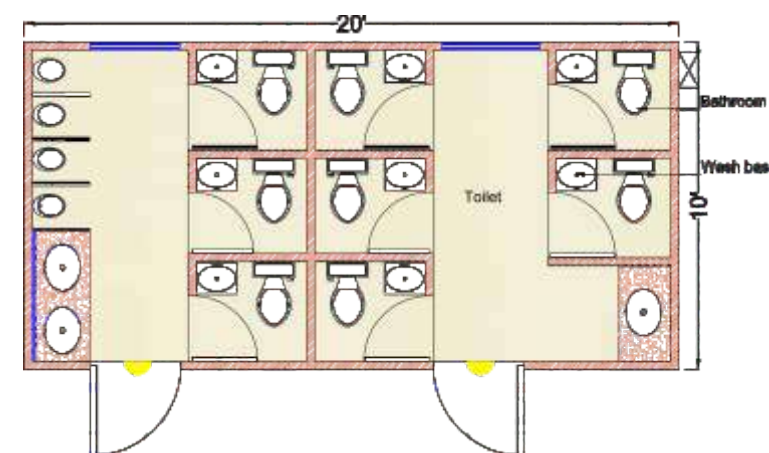

DSG-13

Sizes-20' x 10'
Toilet Block - Gents & Ladies

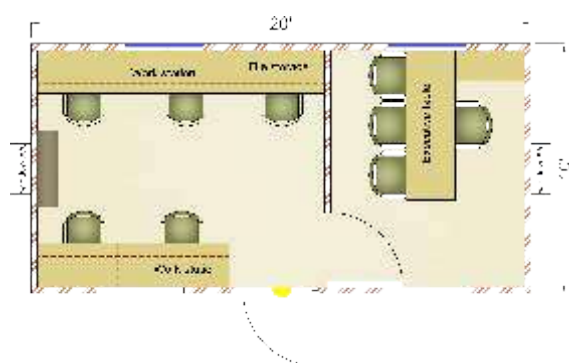

DSG-10

Sizes-20' x 10'
Executive Cabin with 5 Person Work Sation

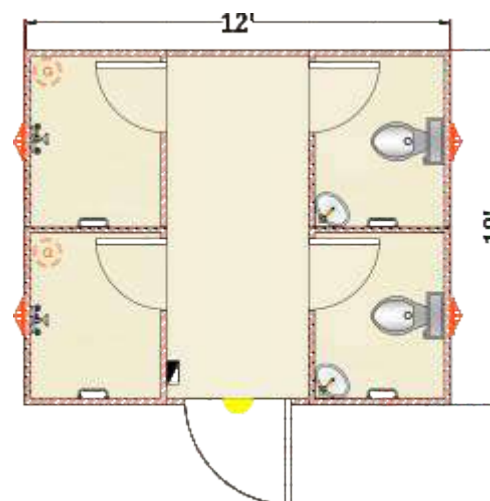

DSG-15

Sizes-12' x 10'
Toilet Block - 2 WC & 2 Bathroom

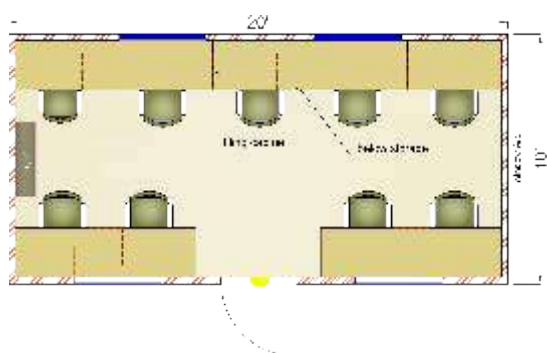

DSG-11

Sizes-20' x 10'
9 Person Work Sation

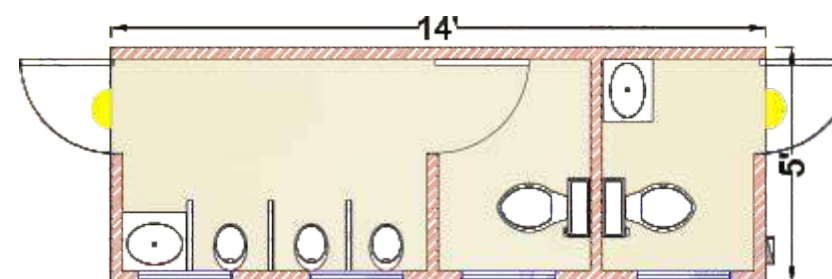

DSG-16

Sizes-14' x 5'
Toilet Block- 2 WC & 3 person Urinal